

PLAN SHOWING THE PROPOSED CONSTRUCTION OF A GROUND FLOOR RESIDENTIAL BUILDING WITH SINGLE DWELLING UNIT  
 AT PLOT NO. 59, "ADITI GARDENZ" IN OLD S.NOs.223/3C & 231/1, PATTI NO.7637 AS PER PATTI NEW S.NOs.231/23 & 223/9  
 OF VENKATAPURAM VILLAGE AND PANCHAYAT, KATTANKULATHUR PANCHAYAT UNION LIMIT, CHENGALPET TALUK, CHENGALPET DISTRICT.

[LAYOUT (REGULARISATION - 2017) APPROVED BY DTCP, CHENGALPET VIDE IN MA.VAJ/NA.OO.TU.I.(SE.MA) NO.244(R) / 2017]

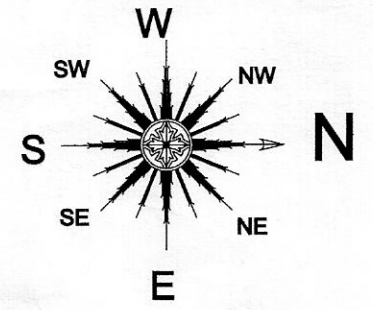

SCALE 1:100

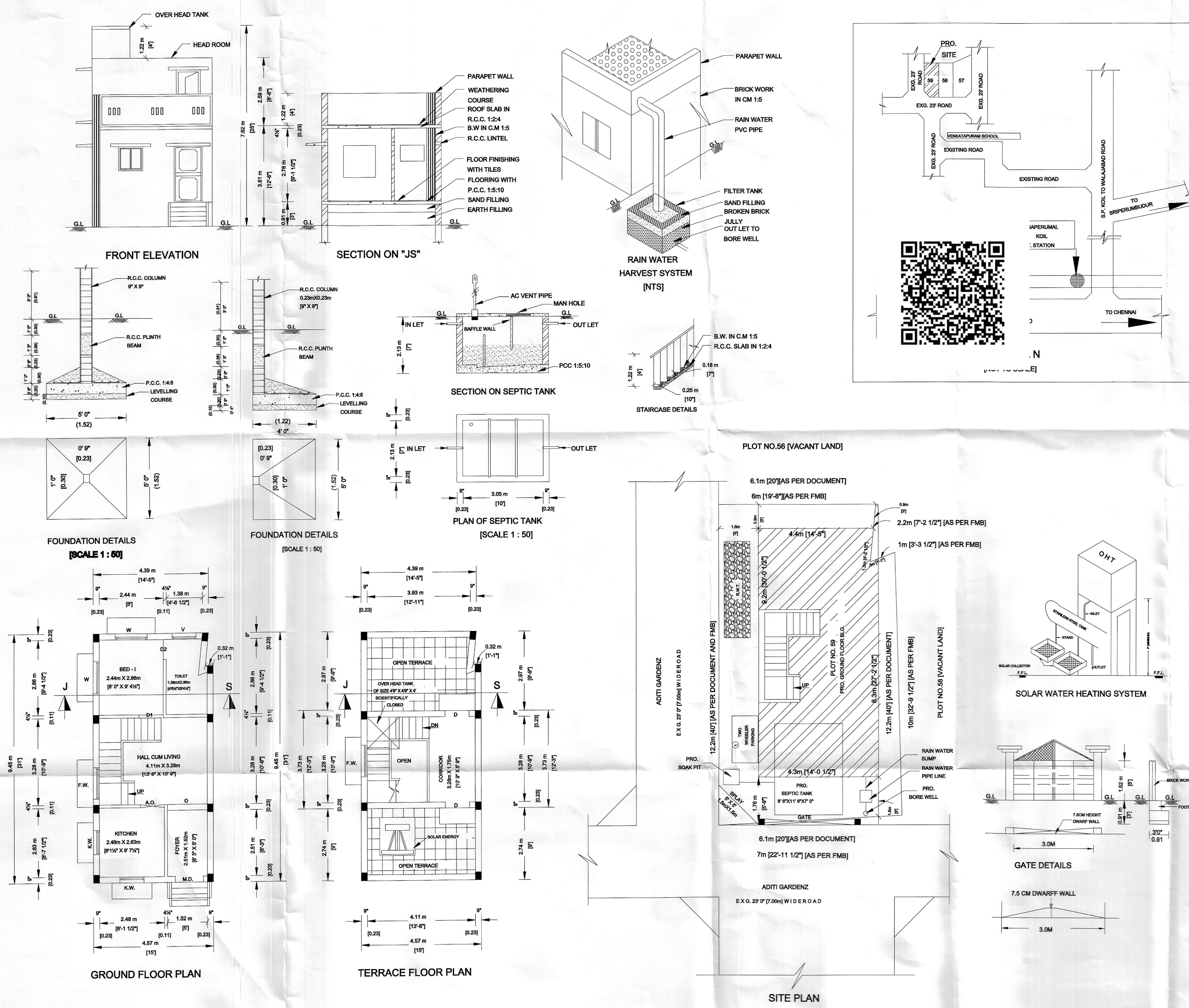

| JOINERY DETAILS |                | IN FT.      | IN M.       |
|-----------------|----------------|-------------|-------------|
| A.O. -          | ARCH OPENING   | 3'0" X 7'0" | 0.91 X 2.13 |
| M.D. -          | MAIN DOOR      | 3'6" X 7'0" | 0.99 X 2.13 |
| O -             | OPEN           | 4'3" X 7'0" | 1.30 X 2.13 |
| D1 -            | DOOR           | 3'0" X 7'0" | 0.91 X 2.13 |
| D2 -            | DOOR           | 2'6" X 7'0" | 0.76 X 2.13 |
| F.W. -          | FRENCH WINDOW  | 5'0" X 6'0" | 1.52 X 1.83 |
| W -             | WINDOW         | 4'0" X 4'0" | 1.22 X 1.22 |
| K.W. -          | KITCHEN WINDOW | 4'0" X 3'0" | 1.22 X 0.91 |
| V -             | VENTILATOR     | 3'0" X 2'0" | 0.91 X 0.61 |

| AREA DETAILS          |  | SQ. FT. | SQ. M. |
|-----------------------|--|---------|--------|
| PLOT EXTENT           |  |         |        |
| AS PER DOCUMENT       |  | 800.00  | 74.32  |
| AS PER PATTI          |  | 797.00  | 74.00  |
| AS PER FMB            |  | 867.00  | 80.54  |
| PRO. G.F. PLINTH AREA |  | 462.00  | 42.91  |
|                       |  |         |        |
| PRO. HEAD ROOM AREA   |  | 164.00  | 17.07  |
| PLOT COVERAGE         |  | 57.9%   |        |
| F.S.I.                |  | 0.58    |        |

| COLOUR INDEX  |  |
|---------------|--|
| PLOT BOUNDARY |  |
| PRO. BLG.     |  |
| ROAD          |  |

| STAIRCASE DETAILS |       | IN FL. | IN M. |
|-------------------|-------|--------|-------|
| WIDTH             | 3'00" | 0.91   |       |
| TREAD             | 0'10" | 0.25   |       |
| RISE              | 0'07" | 0.18   |       |

OWNER SIGNATURE

**S. JEYALAKSHMI, D.C.E.,**  
 Registered Engineer  
 Registration No. CGLRN/REG/GR-III/2019/07015  
 DEPUTY DIRECTOR OF TOWN AND COUNTRY PLANNING,  
 CHENGALPET REGION  
 CHENNAI METROPOLITAN DEVELOPMENT AUTHORITY  
 NANDHIVARAM - GUDUVANCHERY MUNICIPALITY  
 MARAVANALAGAR MUNICIPALITY  
 GREATER CHENNAI CORPORATION  
 TAMBARAM CITY MUNICIPAL CORPORATION  
**JEYSUN ENGINEERS**  
 NO.59 & 60, G.S.T. ROAD, (FIRST FLOOR)  
 URAPAKKAM, CHENNAI 605 216.  
 MOB:9444 219 778, 9824 59660, PH: 044 - 4743 1074  
 jeysun2010@gmail.com, www.jeysunengineers.com  
**REGISTERED ENGINEER**