

**SITE PLAN SHOWING THE PROPOSED SUBDIVISION OF HOUSE SITES IN WARD - E, BLOCK NO - 116,**

**T.S.NO- 2/20, 5/40, 22/4, 22/17, 22/34 (OLD S.NO - 299/4, 302/1,296/5,296/6Pt), VIRUDHACHALAM , VIRUDHACHALAM**

**MUNICIPALITY, VIRUDHACHALAM TALUK, CUDDALORE DISTRICT.**

**Name of the Owner : Thiru.M.Suresh Chand. S/o. Mangal Chand.**



(Scale 1:400)

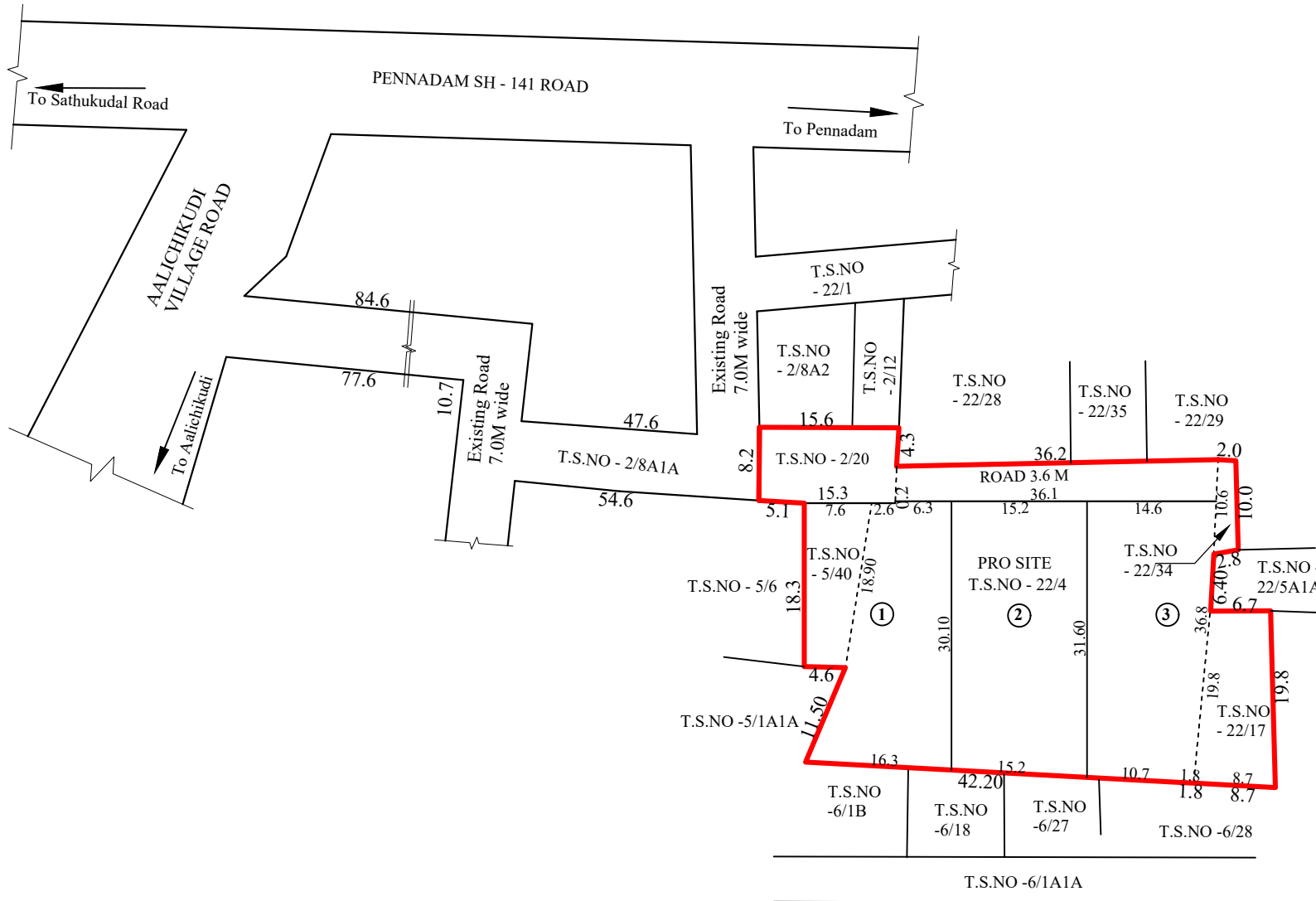

**COLOUR INDEX**

SITE BOUNDARY	
EXISTING ROAD	

**AREA STATEMENT DETAIL**

WARD	BLOCK	T.S.NO	AREA (SMT)
E	116	2/20	130.00
		5/40	113.00
		22/4	1450.00
		22/17	154.00
		22/34	25.00
TOTAL			1872.00

**AREA DETAILS SQMT**

**Area of the Site 1872.00 (Ac.0.46)**

**APPLICANT'S SIGNATURE**

(M. Suresh Chand)