

**PLAN SHOWING THE PROPOSED CONSTRUCTION OF INDUSTRIAL BUILDING GREEN INDUSTRIES "ELECTRONIC & ELECTRICAL GOODS" (ANNEXURE-VI,SL.NO:50),**

**IN SURVEY NO:17/2(AS PER PATTA S.NO:17/2A & 17/2B3)PATTA NOS:798 & 821 OF KATTUR VILLAGE ,VENBEDU VILLAGE PANCHAYAT ,THIRUPORUR PANCHAYAT UNION, THIRUPORUR TALUK,CHENGALPATTU DISTRICT.**

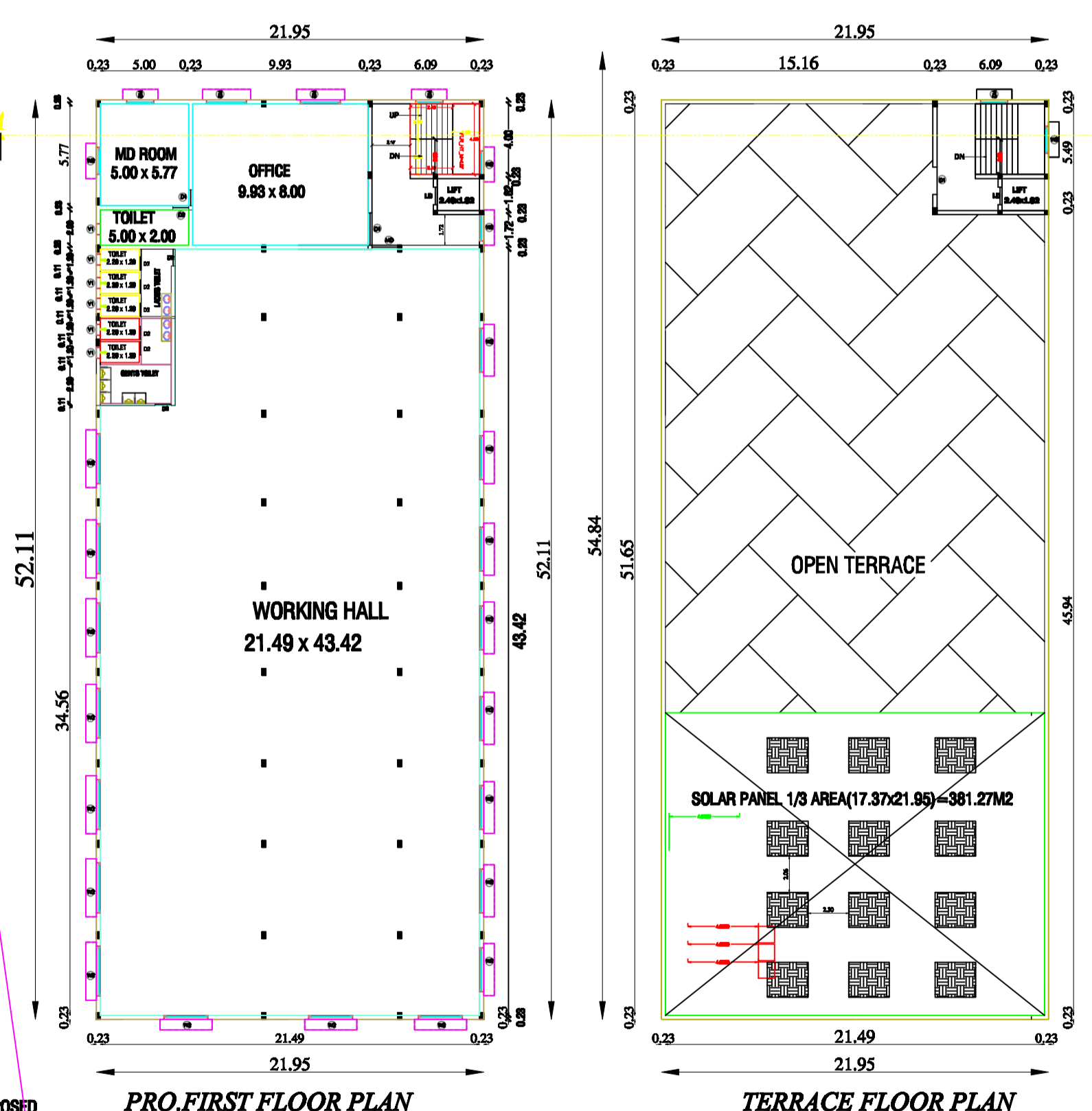

**SITE CUM PRO.GROUND FLOOR PLAN**

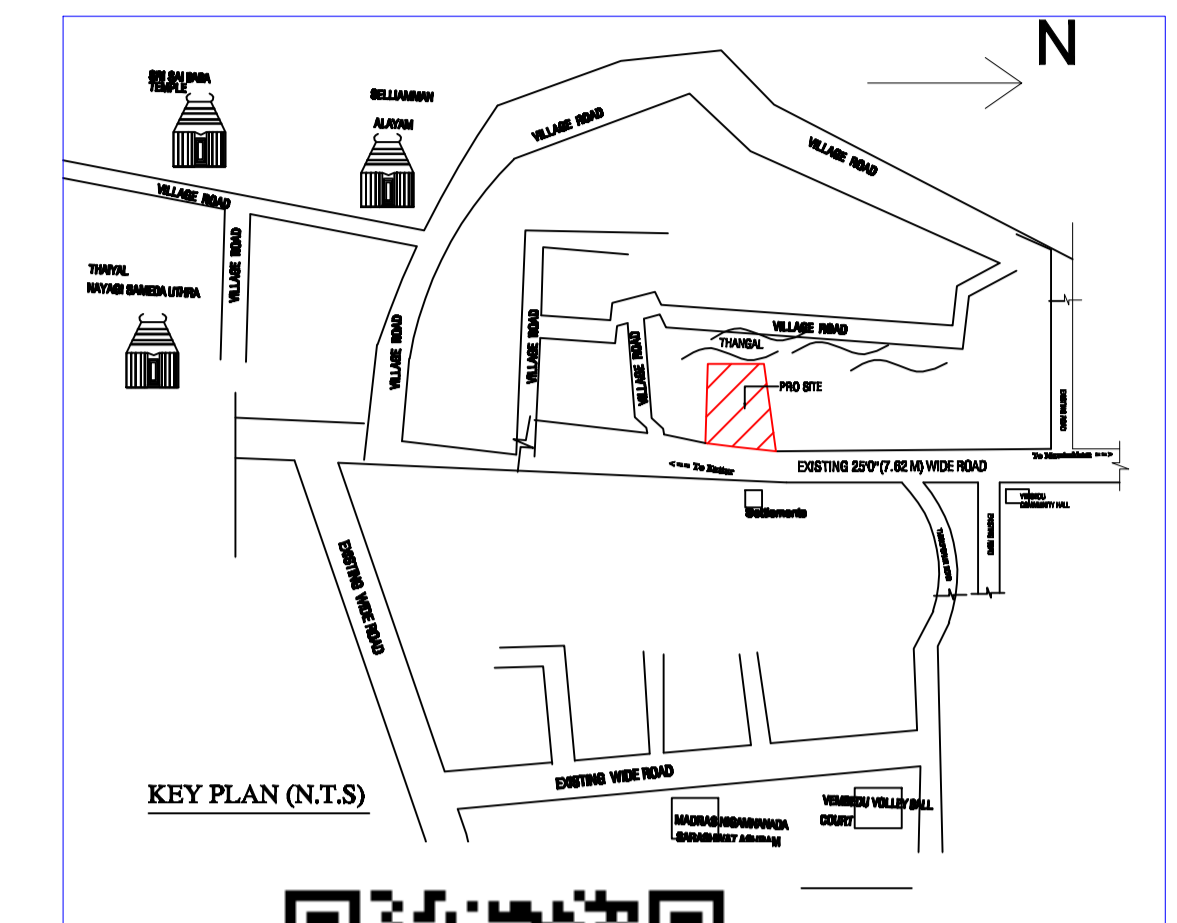
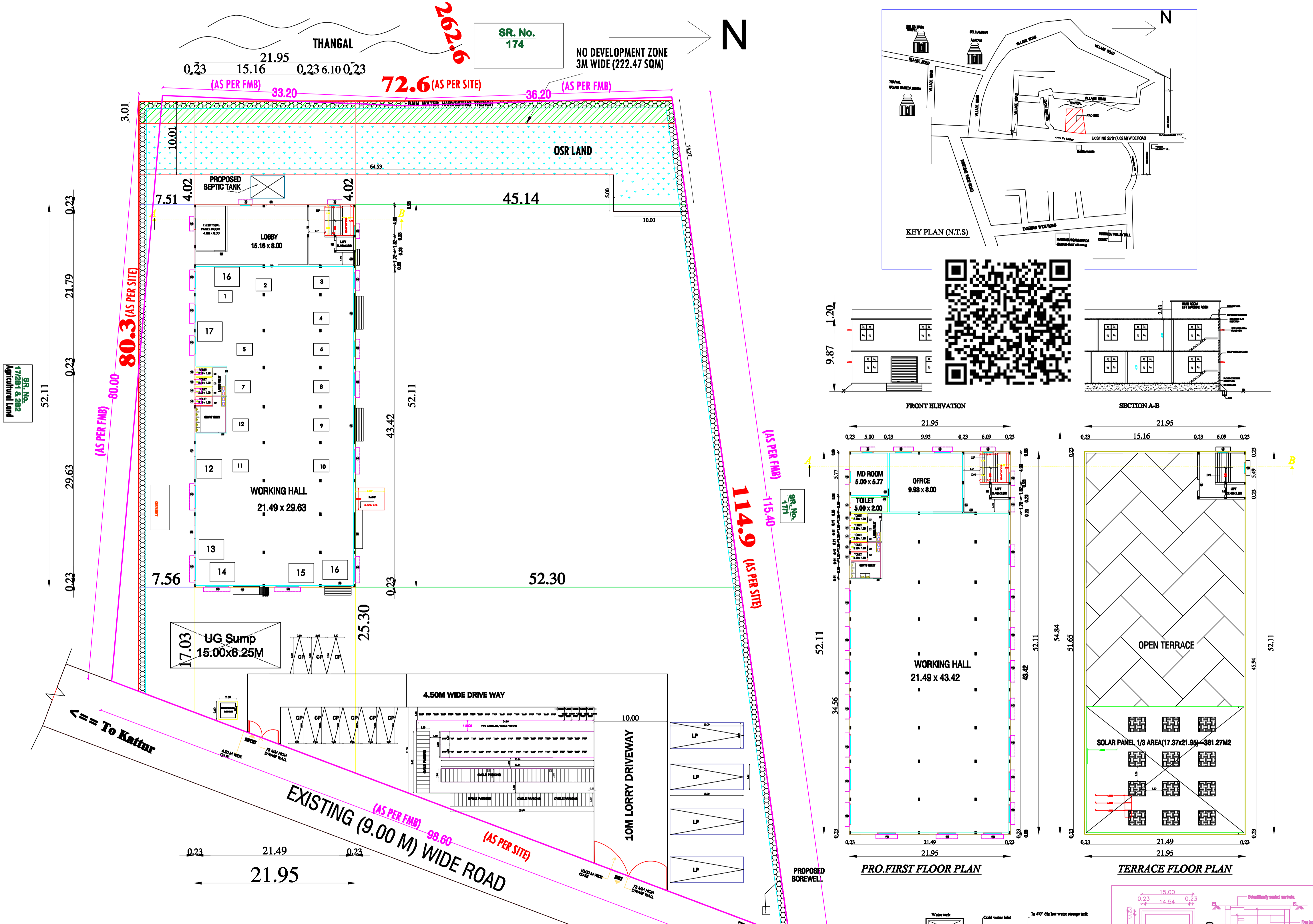
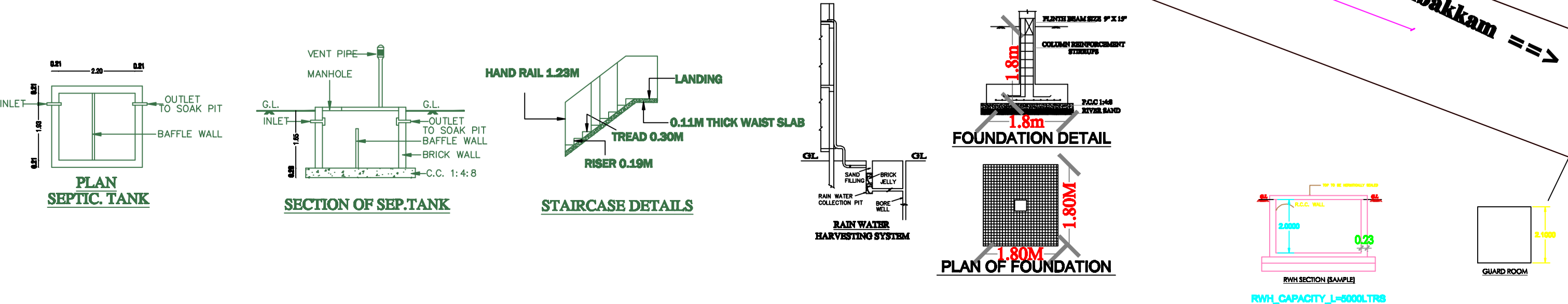

AREA STATEMENT	
PLOT AREA (AS AT PATTA)	7740.00 SQ.M
PLOT AREA (AS AT DOC)	7729.49 SQ.M
PLOT AREA (AS AT SITE)	7690.20 SQ.M
PRO. G.F (WORKSHOP) AREA	918.72 SQ.M
PRO. G.F (OFFICE) AREA	224.96 SQ.M
PRO. F.F (WORKSHOP) AREA	918.72 SQ.M
PRO. F.F (OFFICE) AREA	224.96 SQ.M
HEAD ROOM AREA	38.96 SQ.M
TOTAL FLOOR AREA	2326.32 SQ.M
SECURITY ROOM AREA	6.78 SQ.M
F.S.I = $\frac{\text{TOTAL FLOOR AREA}}{\text{PLOT AREA}} = \frac{2326.32}{7690.20} = 0.30$	
PLOT COVERAGE	15.00%

OSR AREA = 786.0Sq.m  
OSR % = 786.0/7690.20=10.20%

PARKING DETAILS			
	CARS	LORRY	TWO WHEELER
REQUIRED	0	4	36
PROVIDED	9	4	64

NUMBER OF WORKERS	
MALE	35
FEMALE	15

SANITATION DETAILS:		
REQUIRED	PROVIDED	
FEMALE WC	1	6
MALE WC	1	4
URINALS	0	10
HAND WASH	0	4
ABLUTION TAPS	10	27

MACHINERY DETAILS		
SL.No:	DESCRIPTION	Qty
1	Automatic Magazine Loader	2
2	Solder Paste Printer	2
3	Shuttle Conveyor	1
4	Link Conveyor	1
5	3D Solder Paste Inspection	1
6	Reject Conv	2
7	Pick & Place Machine	4
8	Inspection Conv	1
9	Reflow Oven(N2 Oven)	1
10	Cooling Conveyor	1
11	3D Auto Optical Inspection	1
12	Dual Lane Unloader	1
Accessories & Utilities		
13	Phase CBM Material Verification	4
14	Quick Change Over Set-Up	1
15	Air Conditioners	4
17	Exhaust	3
Total		80.00 H.P

JOINERY DETAILS:		
DESCRIPTION	IN METER	
MD MAIN DOOR	1.00X2.13	
D1 DOOR	0.91X2.13	
D2 TOILET DOOR	0.76X2.13	
RS ROLLING SHUTTER	4.50X2.40	
W1 WINDOW	1.60X1.37	
V VENTILATOR	0.91X0.61	

LEGEND	
PROPOSED	ROAD
DEMOLISH	BOUNDRY

OWNER:

**MAITHILI LAKSHMANAN**  
Registered Engineer  
Regn.No.CGLD/IST/RE/Gr-I-2023/10/010  
No.2/28,2nd Main Road,New Colony,  
Chrompet,Chennai - 600044,Ph:9840765783.

REGISTERED ENGINEER  
ONLINE APPLICATION NO:SWP/BPA/0061497/2023  
BUILDING TECHNICAL APPROVAL  
SWP/INDUSTRIAL BUILDING/  
A.D./D.T.C.(CB)NO.06/2024