

PLAN SHOWING THE PROPOSED INDUSTRIAL BUILDING CONSTRUCTION OF MANUFACTURING UNIT (MANUFACTURING POLYESTER BLENDED POLYESTER) AT PLOT NO.6, 9/10 & 44, IN EXTENSION TOWNSHIP, TANDUR, TANDUR THIRUVAHUR DISTRICT, TANJAVUR DISTRICT, TAMIL NADU. TANDUR THIRUVAHUR DISTRICT, TANJAVUR DISTRICT, TAMIL NADU. TANDUR THIRUVAHUR DISTRICT, TANJAVUR DISTRICT, TAMIL NADU. TANDUR THIRUVAHUR DISTRICT, TANJAVUR DISTRICT, TAMIL NADU.

TITLE: MAIN BLOCK - ROOF PLAN



DTP APPROVED LAYOUT NO. 141/2019/1000 (TANJAVUR DISTRICT)

INDUSTRIAL BUILDING

FLOOR PLAN T. 100

COLOR REFERENCE

ROAD: PROPOSED BUILDING
SITE BOUNDARY: PROPOSED MACHINERY

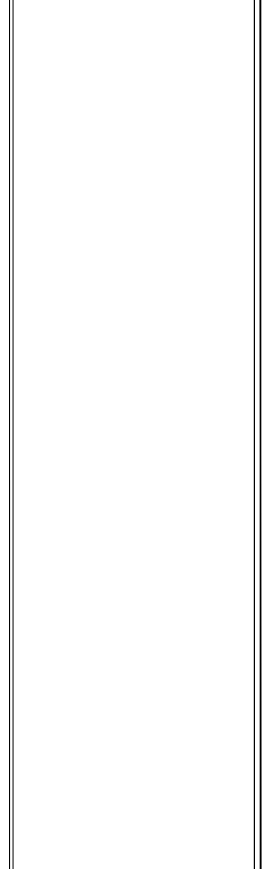

ROOF PLAN
PRODUCTION BLOCK

APPLICANT:

OWNER / OCCUPIER:

STRUCTURAL ENGINEER:

REGISTERED ENGINEER:

PLAN SHOWING THE PROPOSED INDUSTRIAL BUILDING CONSTRUCTION OF MANUFACTURING UNIT M/S. SOFTGEL HEALTHCARE PVT.LTD. AT PLOT NOS: 9, 10, 8, 44, IN S.NOS: 712B1, 712B2, 742B1, 742B2, 713A, 713B, 714A2, 714B2, 72, 73, 74, 75, 76, 77, 78, 79, 80, 81, 82, 83, 84, 85, 86, 87, 88, 89, 90, 91, 92, 93, 94, 95, 96, 97, 98, 99, 100, 101, 102, 103, 104, 105, 106, 107, 108, 109, 110, 111, 112, 113, 114, 115, 116, 117, 118, 119, 120, 121, 122, 123, 124, 125, 126, 127, 128, 129, 130, 131, 132, 133, 134, 135, 136, 137, 138, 139, 140, 141, 142, 143, 144, 145, 146, 147, 148, 149, 150, 151, 152, 153, 154, 155, 156, 157, 158, 159, 160, 161, 162, 163, 164, 165, 166, 167, 168, 169, 170, 171, 172, 173, 174, 175, 176, 177, 178, 179, 180, 181, 182, 183, 184, 185, 186, 187, 188, 189, 190, 191, 192, 193, 194, 195, 196, 197, 198, 199, 200, 201, 202, 203, 204, 205, 206, 207, 208, 209, 210, 211, 212, 213, 214, 215, 216, 217, 218, 219, 220, 221, 222, 223, 224, 225, 226, 227, 228, 229, 230, 231, 232, 233, 234, 235, 236, 237, 238, 239, 240, 241, 242, 243, 244, 245, 246, 247, 248, 249, 250, 251, 252, 253, 254, 255, 256, 257, 258, 259, 260, 261, 262, 263, 264, 265, 266, 267, 268, 269, 270, 271, 272, 273, 274, 275, 276, 277, 278, 279, 280, 281, 282, 283, 284, 285, 286, 287, 288, 289, 290, 291, 292, 293, 294, 295, 296, 297, 298, 299, 300, 301, 302, 303, 304, 305, 306, 307, 308, 309, 310, 311, 312, 313, 314, 315, 316, 317, 318, 319, 320, 321, 322, 323, 324, 325, 326, 327, 328, 329, 330, 331, 332, 333, 334, 335, 336, 337, 338, 339, 340, 341, 342, 343, 344, 345, 346, 347, 348, 349, 350, 351, 352, 353, 354, 355, 356, 357, 358, 359, 360, 361, 362, 363, 364, 365, 366, 367, 368, 369, 370, 371, 372, 373, 374, 375, 376, 377, 378, 379, 380, 381, 382, 383, 384, 385, 386, 387, 388, 389, 390, 391, 392, 393, 394, 395, 396, 397, 398, 399, 400, 401, 402, 403, 404, 405, 406, 407, 408, 409, 410, 411, 412, 413, 414, 415, 416, 417, 418, 419, 420, 421, 422, 423, 424, 425, 426, 427, 428, 429, 430, 431, 432, 433, 434, 435, 436, 437, 438, 439, 440, 441, 442, 443, 444, 445, 446, 447, 448, 449, 450, 451, 452, 453, 454, 455, 456, 457, 458, 459, 460, 461, 462, 463, 464, 465, 466, 467, 468, 469, 470, 471, 472, 473, 474, 475, 476, 477, 478, 479, 480, 481, 482, 483, 484, 485, 486, 487, 488, 489, 490, 491, 492, 493, 494, 495, 496, 497, 498, 499, 500, 501, 502, 503, 504, 505, 506, 507, 508, 509, 510, 511, 512, 513, 514, 515, 516, 517, 518, 519, 520, 521, 522, 523, 524, 525, 526, 527, 528, 529, 530, 531, 532, 533, 534, 535, 536, 537, 538, 539, 540, 541, 542, 543, 544, 545, 546, 547, 548, 549, 550, 551, 552, 553, 554, 555, 556, 557, 558, 559, 560, 561, 562, 563, 564, 565, 566, 567, 568, 569, 570, 571, 572, 573, 574, 575, 576, 577, 578, 579, 580, 581, 582, 583, 584, 585, 586, 587, 588, 589, 590, 591, 592, 593, 594, 595, 596, 597, 598, 599, 600, 601, 602, 603, 604, 605, 606, 607, 608, 609, 610, 611, 612, 613, 614, 615, 616, 617, 618, 619, 620, 621, 622, 623, 624, 625, 626, 627, 628, 629, 630, 631, 632, 633, 634, 635, 636, 637, 638, 639, 640, 641, 642, 643, 644, 645, 646, 647, 648, 649, 650, 651, 652, 653, 654, 655, 656, 657, 658, 659, 660, 661, 662, 663, 664, 665, 666, 667, 668, 669, 670, 671, 672, 673, 674, 675, 676, 677, 678, 679, 680, 681, 682, 683, 684, 685, 686, 687, 688, 689, 690, 691, 692, 693, 694, 695, 696, 697, 698, 699, 700, 701, 702, 703, 704, 705, 706, 707, 708, 709, 710, 711, 712, 713, 714, 715, 716, 717, 718, 719, 720, 721, 722, 723, 724, 725, 726, 727, 728, 729, 730, 731, 732, 733, 734, 735, 736, 737, 738, 739, 740, 741, 742, 743, 744, 745, 746, 747, 748, 749, 750, 751, 752, 753, 754, 755, 756, 757, 758, 759, 760, 761, 762, 763, 764, 765, 766, 767, 768, 769, 770, 771, 772, 773, 774, 775, 776, 777, 778, 779, 780, 781, 782, 783, 784, 785, 786, 787, 788, 789, 790, 791, 792, 793, 794, 795, 796, 797, 798, 799, 800, 801, 802, 803, 804, 805, 806, 807, 808, 809, 810, 811, 812, 813, 814, 815, 816, 817, 818, 819, 820, 821, 822, 823, 824, 825, 826, 827, 828, 829, 830, 831, 832, 833, 834, 835, 836, 837, 838, 839, 840, 841, 842, 843, 844, 845, 846, 847, 848, 849, 850, 851, 852, 853, 854, 855, 856, 857, 858, 859, 860, 861, 862, 863, 864, 865, 866, 867, 868, 869, 870, 871, 872, 873, 874, 875, 876, 877, 878, 879, 880, 881, 882, 883, 884, 885, 886, 887, 888, 889, 890, 891, 892, 893, 894, 895, 896, 897, 898, 899, 900, 901, 902, 903, 904, 905, 906, 907, 908, 909, 910, 911, 912, 913, 914, 915, 916, 917, 918, 919, 920, 921, 922, 923, 924, 925, 926, 927, 928, 929, 930, 931, 932, 933, 934, 935, 936, 937, 938, 939, 940, 941, 942, 943, 944, 945, 946, 947, 948, 949, 950, 951, 952, 953, 954, 955, 956, 957, 958, 959, 960, 961, 962, 963, 964, 965, 966, 967, 968, 969, 970, 971, 972, 973, 974, 975, 976, 977, 978, 979, 980, 981, 982, 983, 984, 985, 986, 987, 988, 989, 990, 991, 992, 993, 994, 995, 996, 997, 998, 999, 1000.

TITLE: SITE PLAN

DTCP APPROVED LAYOUT NO: (This Revised L.P./D.T.C.P.No - 172013)

MANUFACTURING DETAILS: TNPCB - ORANGE CATEGORY
SCALE: SITE PLAN - 1:400, FLOOR PLAN 1: 100

AREA STATEMENT (Sq.m)

TOTAL PLOT AREA : 39,234.50 Sq.mt (OR) 9.695 Acres

S.NO	BLOCK NAME	FLOOR NAME	F.S AREA (Sq.m)	NO. OF FLOORS	TOTAL BUILDUP AREA	BUILDING HEIGHT
1.	MAIN BLOCK	GROUND FLOOR	12,583.36	1	12,583.36	17.52
		FIRST FLOOR	7,286.11	1	21,971.65	17.52
2.	UTILITY BLOCK	GROUND FLOOR	1976.50	1	1976.50	18.00
		FIRST FLOOR	444.44	1	2,465.38	18.00
3.	SECURITY BLOCK	GROUND FLOOR	250.00	1	250.00	4.30
		FIRST FLOOR	24.00	1	24.00	3.80
4.	SECURITY BLOCK	GROUND FLOOR	24.00	1	24.00	3.80
		FIRST FLOOR	44.44	1	2,465.38	18.00
5.	ETP	GROUND FLOOR	438.75	1	438.75	3.04
		FIRST FLOOR	85.93	1	85.93	3.24
6.	FIRE WATER TANK	GROUND FLOOR	85.93	1	85.93	3.24
		FIRST FLOOR	85.93	1	85.93	3.24
TOTAL AREA in Sqm			24,911.90		24,911.90	

F.S.U : TOTAL F.S AREA = 24,911.90
TOTAL PLOT AREA = 39,234.50 = 0.634

MAN POWER DETAILS

Category	Count	Rate	Total
MALE WORKERS	475 NOS	1.00	475.00
FEMALE WORKERS	375 NOS	0.50	187.50
TOTAL WORKERS	850 NOS		662.50

HP DETAILS

Category	Count	Rate	Total
1. SHEET NO-01	1	1,009.60	1,009.60
2. SHEET NO-02	1	576.00	576.00
3. SHEET NO-09	1	1,848.00	1,848.00
TOTAL HP	3		3,433.60

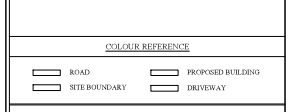

APPLICANT: M/S. SOFTGEL HEALTHCARE PVT. LTD.

OWNER/OCCUPYER: D. SHANMUGASUBRAMANIAM

STRUCTURAL ENGINEER G-1: S. SHANMUGASUBRAMANIAM

REGISTERED ENGINEER G-1: S. SHANMUGASUBRAMANIAM

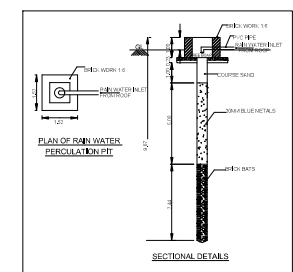
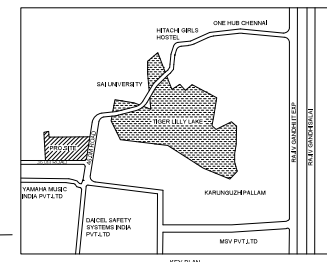

PARKING DETAILS

PARKING	REQUIRED	PROVIDED
LORRY PARKING	40 Nos	40 Nos
CAR PARKING	10 Nos	12 Nos
PH CAR PARKING	7 Nos	3 Nos
TWO WHEELER PARKING	397 Nos	400 Nos
PH TWO WHEELER PARKING	15 Nos	15 Nos
CYCLE PARKING	397 Nos	400 Nos

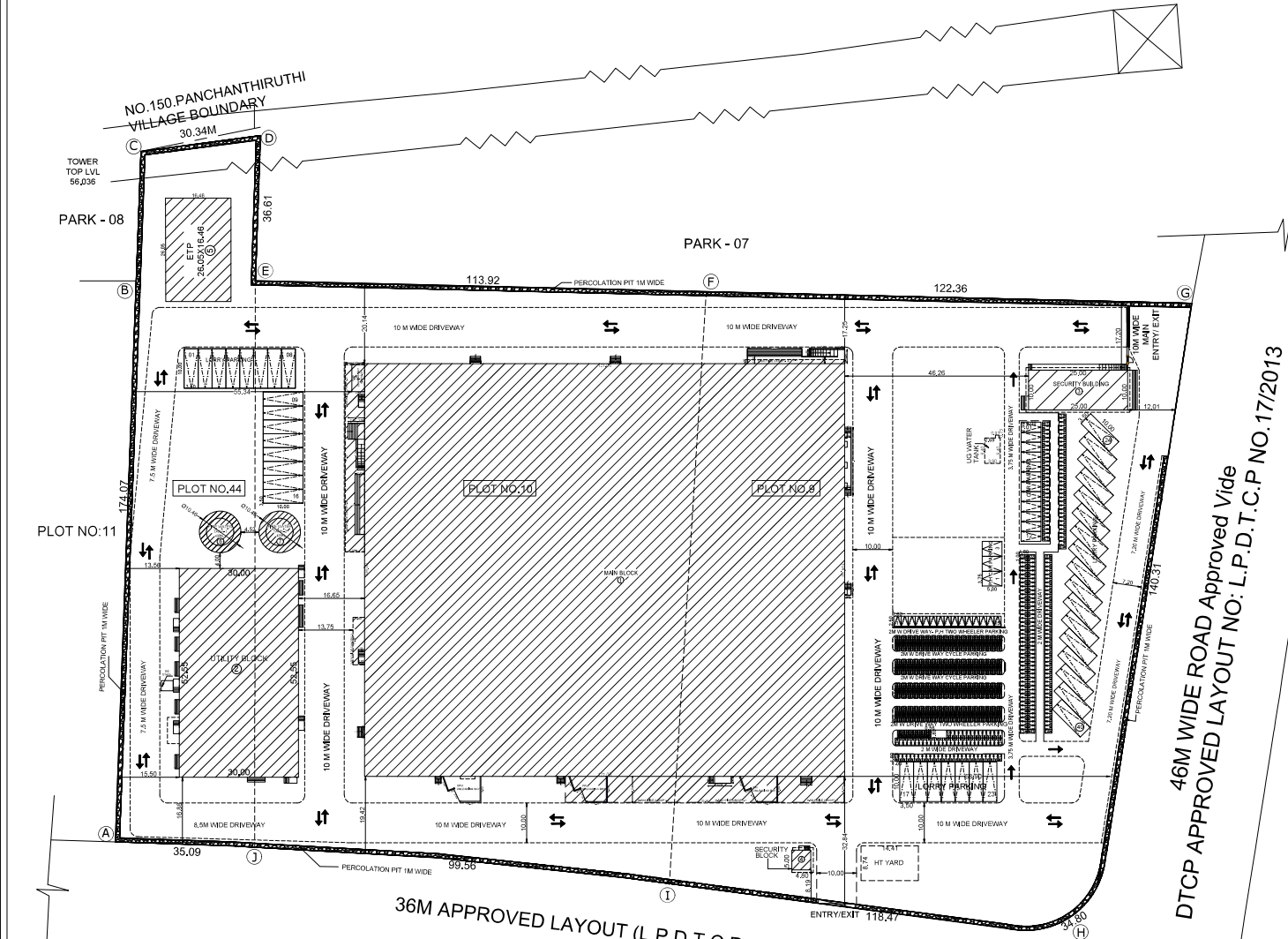
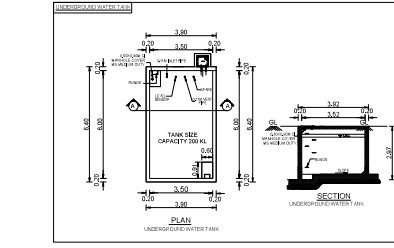
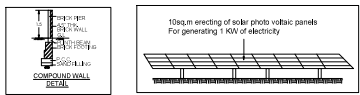
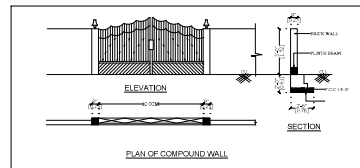

SITE PLAN SCALE 1:400

46M WIDE ROAD Approved Vide DTCP APPROVED LAYOUT NO: L.P.D.T.C.P NO.17/2013

36M APPROVED LAYOUT (L.P.D.T.C.P NO.17/2013) ROAD

